

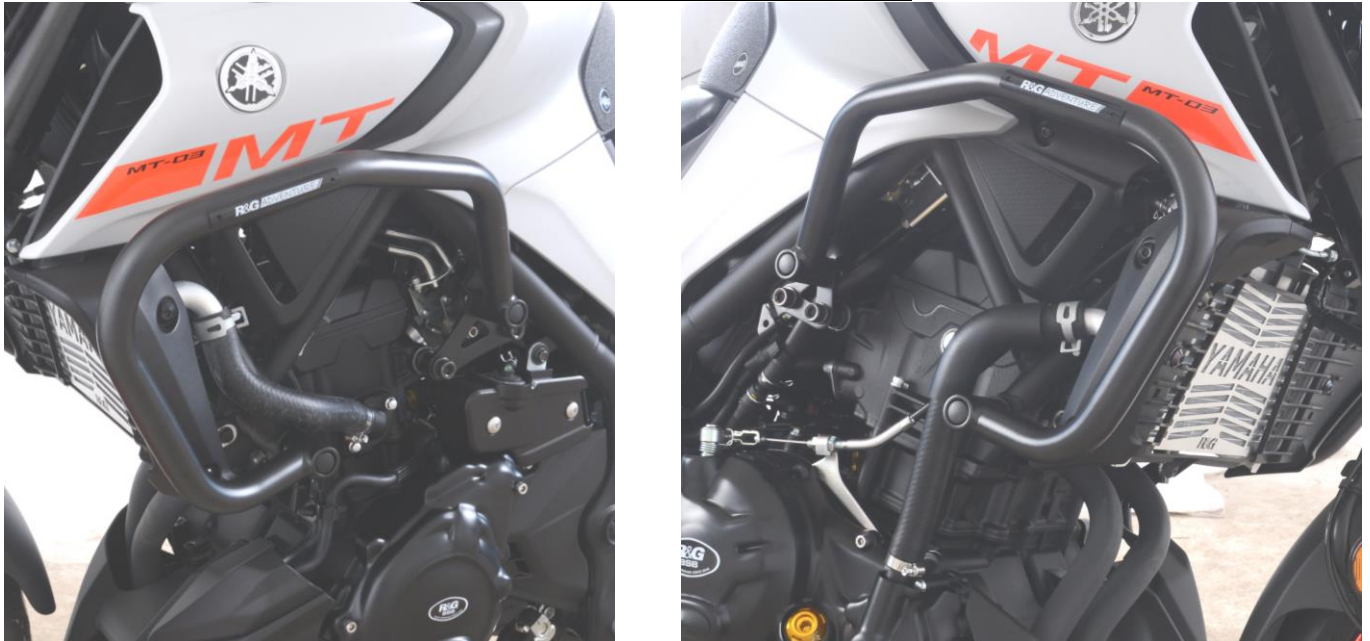

**FITTING INSTRUCTIONS FOR AB0069 ADVENTURE BARS
FOR YAMAHA MT-03 2020-**



THIS KIT CONTAINS THE ITEMS PICTURED AND LABELLED OVER PAGE.

SOME PARTS MAY BE SHOWN FOR CLARITY OF INSTRUCTIONS ONLY.

DO NOT PROCEED UNTIL YOU ARE SURE ALL PARTS ARE PRESENT.

PLEASE READ ALL INSTRUCTIONS BEFORE PROCEEDING.

**IF IN ANY DOUBT WHEN FITTING OUR PRODUCTS, CONSULT ONE OF
OUR DEALERS OR HAVE FITTED BY A QUALIFIED TECHNICIAN.**

PLEASE NOTE THAT THE WAY THE KIT IS PACKED DOES NOT NECESSARILY REPRESENT THE
WAY OF MOUNTING TO THE BIKE.

IN THE EVENT OF RUBBER WASHERS BEING USED TO HOLD COMPONENTS ONTO BOLTS,
THESE RUBBER WASHERS CAN BE THROWN AWAY.

DIGITAL COPIES OF THESE INSTRUCTIONS ARE AVAILABLE FROM:

WWW.RG-RACING.COM



<u>TOOLS REQUIRED</u>	<u>GENERAL TORQUE SETTINGS</u>
<ul style="list-style-type: none"> • Set of metric Allen keys or socket bits to include 8mm A/F size. • Torque wrench (up-to 40Nm). • Suitable Jack or support mechanism. • Block of wood or plastic. 	<p>M4 BOLT = 8Nm M5 BOLT = 12Nm M6 BOLT = 15Nm M8 BOLT = 20Nm M10 BOLT = 40Nm M12 BOLT = 40Nm</p>

LEGEND

ITEM NO.	DESCRIPTION	QTY
ITEM 1	ADVENTURE BAR LEFT-HAND SIDE (AB0069 LHS ASSEMBLY)	1
ITEM 2	M10x1.25x55mm LONG CAP HEAD BOLTS	2
ITEM 3	M10 FLAT CAPS (NC0010)	4
ITEM 4	M10x1.25x115mm LONG CAP HEAD BOLTS	2
ITEM 5	ADVENTURE BAR RIGHT-HAND SIDE (AB0069 RHS ASSEMBLY)	1

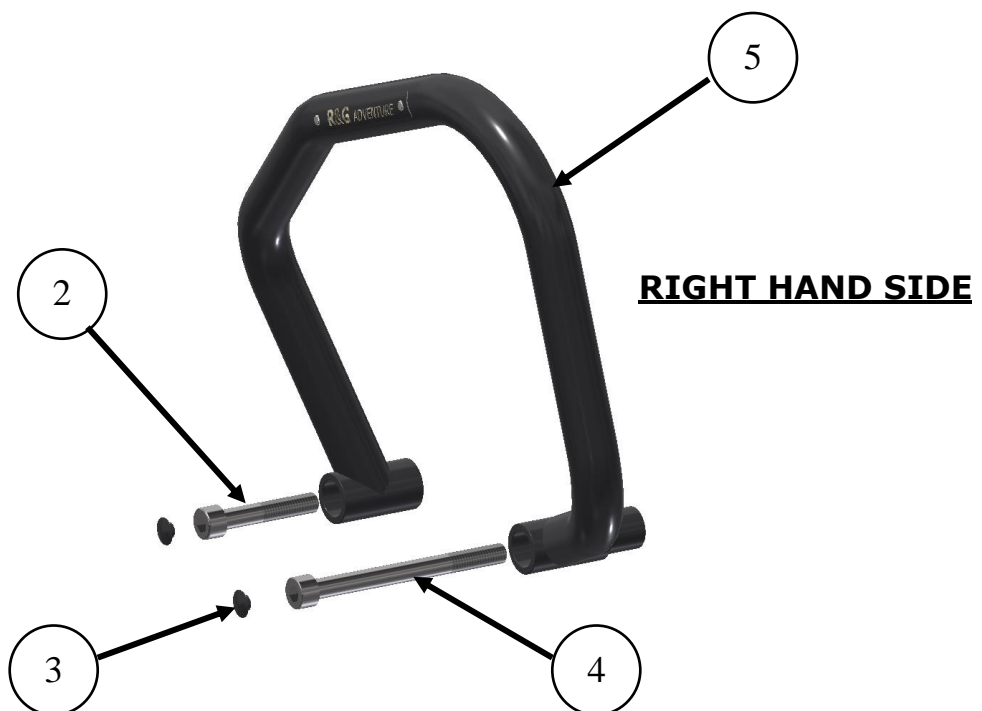
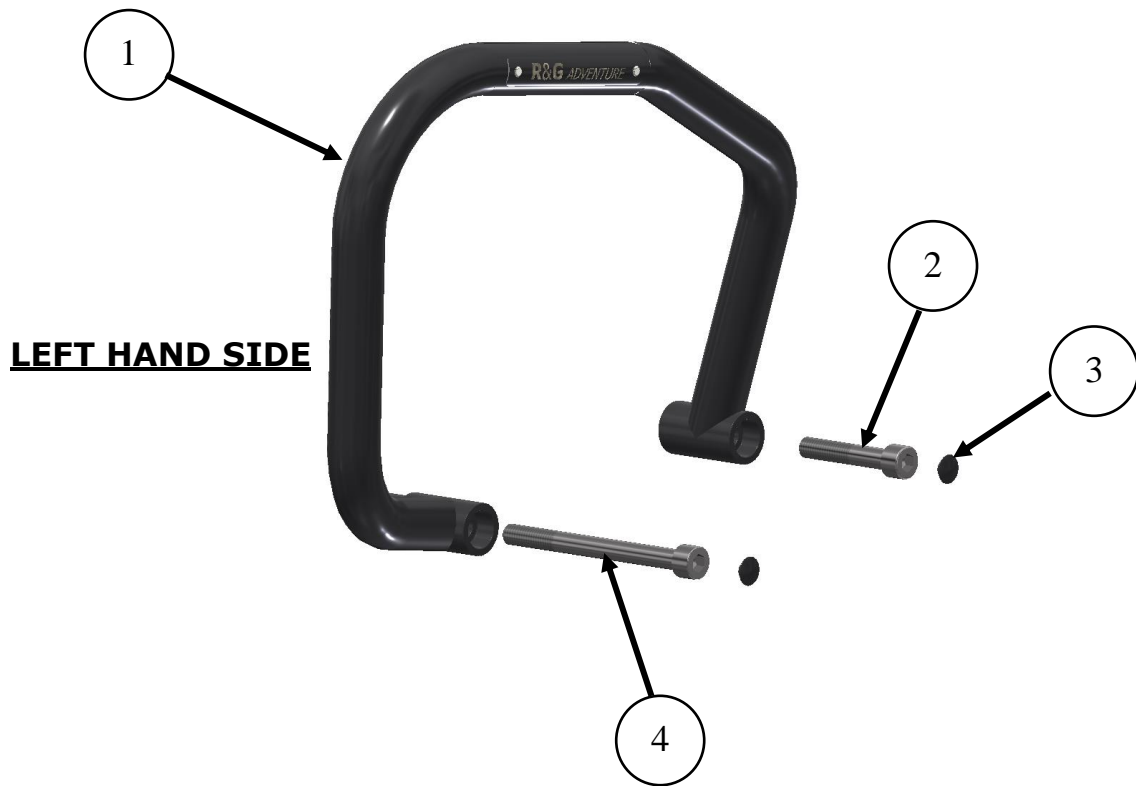

ASSEMBLY DIAGRAMS



PICTURE 1



PICTURE 2



PICTURE 3



PICTURE 4



PICTURE 5

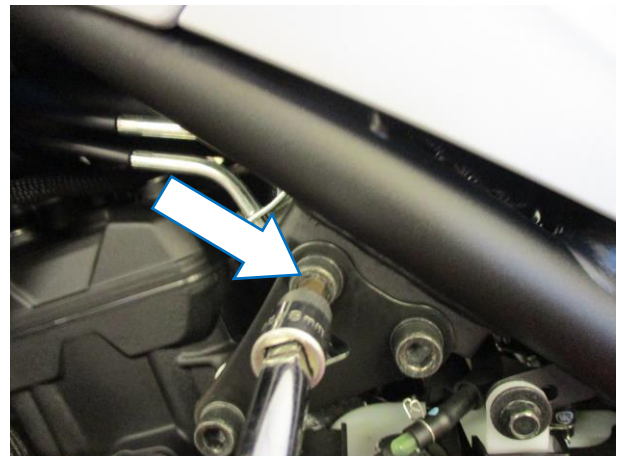

PICTURE 6



FITTING INSTRUCTIONS

- **It is advisable to support the engine with a jack and block of wood/plastic as shown in picture 1 to prevent any engine movement when the original engine bolts are loosened/removed (do not use excessive lifting forces as damage can occur).**

Off side (right side as you sit on the motorcycle)

- Remove the frame tube cover and remove the bolt arrowed in **picture 2**.
- Remove the bolt arrowed in **picture 3**.
- Offer the right-hand side adventure bar (**item 5**) into position as shown in **picture 4**.
- Engage one of the longer bolts (**item 4**) through the front mount and into the engine-mount (do not fully tighten at this stage).
- Engage one of the shorter bolts (**item 2**) through the rear mount and into the engine-mount (do not fully tighten at this stage).
- Tighten both bolts ensuring no parts of the adventure bars contact any motorcycle parts.
- Fit the bolt covers (**item 3**) into the bolt heads.

Near side (left side as you sit on the motorcycle)

- Remove the frame tube cover and remove the bolt arrowed in **picture 5**.
- Remove the bolt arrowed in **picture 6**.
- Offer the right-hand side adventure bar (**item 1**) into position as shown in the **top picture**.
- Engage one of the longer bolts (**item 4**) through the front mount and into the engine-mount (do not fully tighten at this stage).
- Engage one of the shorter bolts (**item 2**) through the rear mount and into the engine-mount (do not fully tighten at this stage).
- Tighten both bolts ensuring no parts of the adventure bars contact any motorcycle parts.
- Fit the bolt covers (**item 3**) into the bolt heads.
- **Before riding, please recheck tightness of all bolts, and the operation of the motorcycle at full lock in both directions.**

ISSUE 1 12/04/2021 (NSY)

CONSUMER NOTICE

The catalogue description and any exhibition of samples are only broad indications of the Products and R&G may make design changes which do not diminish their performance or visual appeal and supplying them in such state shall conform to the order. The Buyer acknowledges no representation or warranty (other than as to title) has been given or will apply to the Products other than those in R&G's order or confirmation and the Buyer confirms it has chosen the Products as being of merchantable quality and suitable for its particular purposes. Where R&G fits the Products or undertakes other services it shall exercise reasonable skill and care and rectify any fault free of charge unless the workmanship has been disturbed. The Buyer is responsible for ensuring that the warranty on the motorcycle is not affected by the fitting of the Products. On return of any defective Products R&G shall at its option either supply a replacement or refund the purchase money but shall not be liable if the Products have been modified or used or maintained otherwise than in accordance with R&G's or manufacturer's instructions and good engineering practice or if the defect arises from accident or neglect. Other than identified above and subject to R&G not limiting its liability for causing death and personal injury, it shall not be liable for indirect or consequential loss and otherwise its liability shall be limited to the amounts paid by the Buyer for the Products or the fitting or service concerned. These terms do not affect the Buyer's statutory rights.

R&G

Unit 1, Shelley's Lane, East Worldham, Alton, Hampshire, GU34 3AQ
Tel: +44 (0)1420 89007 Fax: +44 (0)1420 87301 www.rg-racing.com Email: info@rg-racing.com



R&G RETURNS POLICY (NON-FAULTY GOODS)

Returns must be pre-authorized (if not pre-authorized the return will be rejected). Goods may only be returned direct to us if they were purchased direct from us (customer must prove if necessary). Otherwise to be returned to original vendor. Goods must be in re-sellable condition, in the opinion of R&G. All returns are subject to a 25% restocking and handling fee (25% of the gross value exc. P&P – at the prevailing price at time of purchase). The customer must pay any and all carriage charges. No returns of discontinued products, unless within 14 days of purchase. This policy does not affect your statutory rights and does not refer to faulty goods.



**NOTICE DE MONTAGE AB0069 BARRES AVENTURE
POUR YAMAHA MT-03 2020-**



CE KIT CONTIENT LES ARTICLES ILLUSTRÉS ET ÉTIQUETES SUR LA PAGE.

CERTAINES PARTIES PEUVENT ÊTRE PRÉSENTES UNIQUEMENT POUR LA CLARTE DES INSTRUCTIONS.

NE PAS PROCÉDER AU MONTAGE TANT QUE VOUS N'ÊTES PAS SÛR QUE TOUTES LES PIÈCES SOIENT PRÉSENTES.

VEUILLEZ LIRE TOUTES LES INSTRUCTIONS AVANT DE CONTINUER.

EN CAS DE DOUTE LORS DU MONTAGE DE NOS PRODUITS, CONSULTEZ UN DE NOS REVENDEURS OU FAITES APPEL À UN TECHNICIEN QUALIFIÉ.

VEUILLEZ NOTER QUE LA FAÇON DONT LE KIT EST EMBALLÉ NE REPRÉSENTE PAS NECESSAIREMENT LA MANIÈRE DE LE MONTER SUR LA MOTO.

SI DES RONDELLES EN CAOUTCHOUC SONT UTILISÉES POUR MAINTENIR LES COMPOSANTS SUR LES BOULONS, ELLES PEUVENT ÊTRE JETÉES.

NOTICE DISPONIBLE AU TÉLÉCHARGEMENT SUR :

WWW.RG-RACING.COM



<u>TOOLS REQUIRED</u>	<u>VALEURS DE SERRAGE</u>
<ul style="list-style-type: none"> • Clés Allen 8mm. • Clé dynamométrique (à 40Nm). <ul style="list-style-type: none"> • Prise. • Bloc de bois. 	M4 BOULON = 8Nm M5 BOULON = 12Nm M6 BOULON = 15Nm M8 BOULON = 20Nm M10 BOULON = 40Nm M12 BOULON = 40Nm

LÉGENDE

ARTICLE NO.	DESCRIPTION	QTÉ
ARTICLE 1	BARRE AVENTURE CÔTÉ GAUCHE (AB0069 ASSEMBLAGE CÔTÉ GAUCHE)	1
ARTICLE 2	M10x1.25x55mm BOULONS	2
ARTICLE 3	M10 CAPUCHONS PLATS (NC0010)	4
ARTICLE 4	M10x1.25x115mm BOULONS	2
ARTICLE 5	BARRE AVENTURE CÔTÉ DROIT (AB0069 ASSEMBLAGE CÔTÉ DROIT)	1

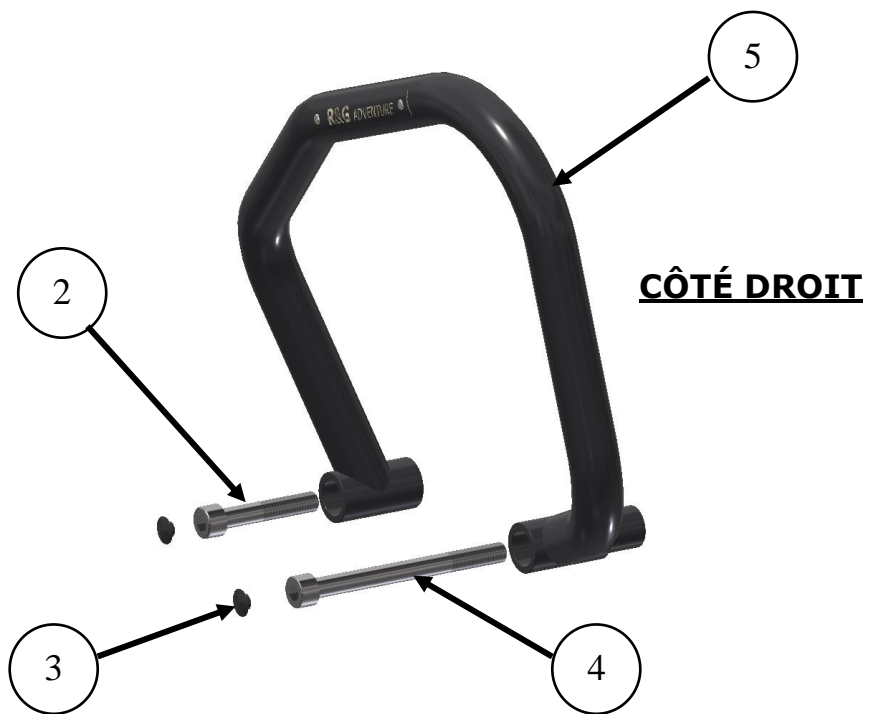
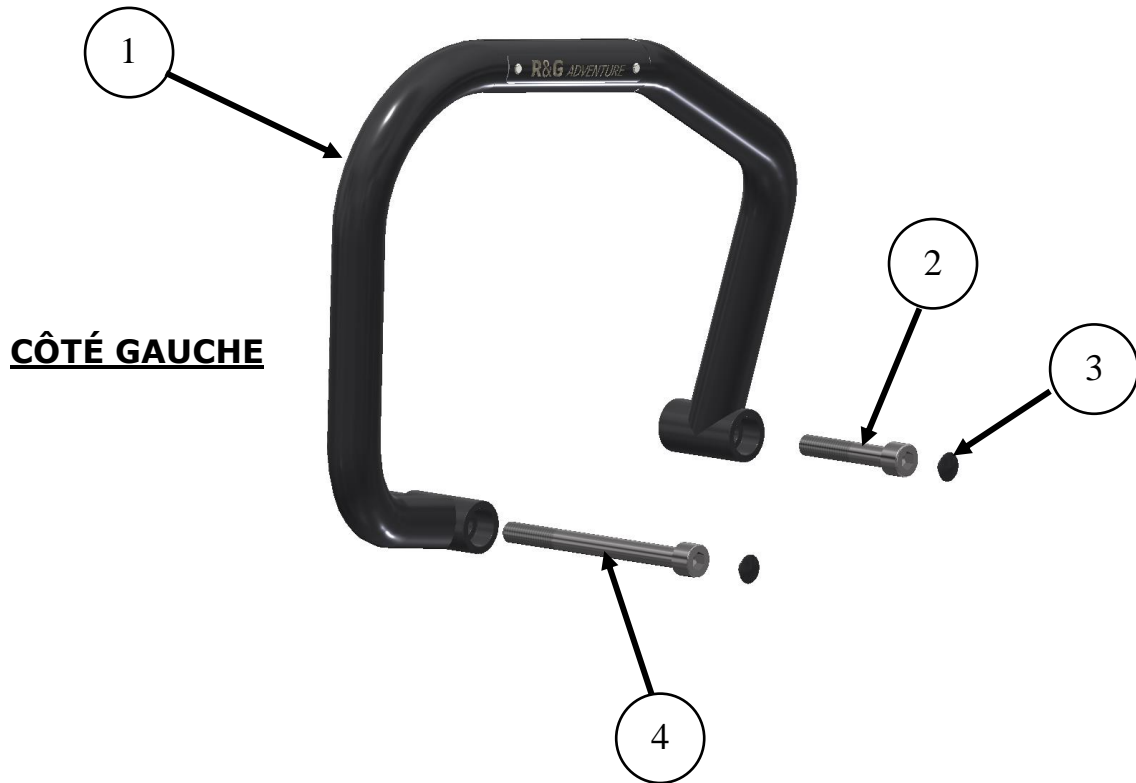

SCHÉMAS D'ENSEMBLE

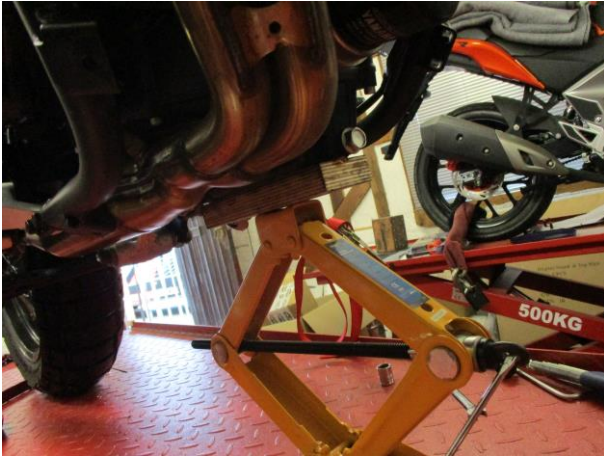

PHOTO 1



PHOTO 2



PHOTO 3



PHOTO 4



PHOTO 5



PHOTO 6



NOTICE DE MONTAGE

- **Il est conseillé de soutenir le moteur avec un cric et un bloc de bois / plastique comme indiqué sur la photo 1 pour éviter tout mouvement du moteur lorsque les boulons d'origine du moteur sont desserrés / retirés (ne pas utiliser de forces de levage excessives car des dommages peuvent survenir).**

Côté droit (lorsqu'on est assis sur la moto)

- Retirez le couvercle du tube de cadre et retirez le boulon indiqué sur la photo 2.
- Retirez le boulon indiqué sur la photo 3.
- Mettez en place la barre aventure côté droit (article 5) comme indiqué sur la photo 4.
- Engagez l'un des boulons les plus longs (article 4) dans le support avant et dans le support moteur (ne serrez pas complètement à ce stade).
- Engagez l'un des boulons les plus courts (article 2) dans le support arrière et dans le support moteur (ne serrez pas complètement à ce stade).
- Serrez les deux boulons en vous assurant qu'aucune partie des barres aventure n'entre en contact avec les pièces de la moto.
- Monter les couvercles de boulons (article 3) sur les têtes de boulons.

Côté gauche (lorsqu'on est assis sur la moto)

- Retirez le couvercle du tube du cadre et retirez le boulon indiqué sur la photo 5.
- Retirez le boulon indiqué sur la photo 6.
- Présentez la barre aventure côté droit (article 1) en position comme indiqué sur la photo du haut.
- Engagez l'un des boulons les plus longs (article 4) dans le support avant et dans le support moteur (ne serrez pas complètement à ce stade).
- Engagez l'un des boulons les plus courts (article 2) dans le support arrière et dans le support moteur (ne serrez pas complètement à ce stade).
- Serrez les deux boulons en vous assurant qu'aucune partie des barres aventure n'entre en contact avec les pièces de la moto.
- Montez les couvercles de boulons (article 3) sur les têtes de boulons.
- Avant de rouler, veuillez vérifier le serrage de tous les boulons et le fonctionnement de la moto à verrouillage complet dans les deux sens.

ISSUE 1 12/04/2021 (NSY)

CONSUMER NOTICE

The catalogue description and any exhibition of samples are only broad indications of the Products and R&G may make design changes which do not diminish their performance or visual appeal and supplying them in such state shall conform to the order. The Buyer acknowledges no representation or warranty (other than as to title) has been given or will apply to the Products other than those in R&G's order or confirmation and the Buyer confirms it has chosen the Products as being of merchantable quality and suitable for its particular purposes. Where R&G fits the Products or undertakes other services it shall exercise reasonable skill and care and rectify any fault free of charge unless the workmanship has been disturbed. The Buyer is responsible for ensuring that the warranty on the motorcycle is not affected by the fitting of the Products. On return of any defective Products R&G shall at its option either supply a replacement or refund the purchase money but shall not be liable if the Products have been modified or used or maintained otherwise than in accordance with R&G's or manufacturer's instructions and good engineering practice or if the defect arises from accident or

R&G

Unit 1, Shelley's Lane, East Worldham, Alton, Hampshire, GU34 3AQ
Tel: +44 (0)1420 89007 Fax: +44 (0)1420 87301 www.rg-racing.com Email: info@rg-racing.com



neglect. Other than identified above and subject to R&G not limiting its liability for causing death and personal injury, it shall not be liable for indirect or consequential loss and otherwise its liability shall be limited to the amounts paid by the Buyer for the Products or the fitting or service concerned. These terms do not affect the Buyer's statutory rights.

R&G RETURNS POLICY (NON-FAULTY GOODS)

Returns must be pre-authorized (if not pre-authorized the return will be rejected). Goods may only be returned direct to us if they were purchased direct from us (customer must prove if necessary). Otherwise to be returned to original vendor. Goods must be in re-sellable condition, in the opinion of R&G. All returns are subject to a 25% restocking and handling fee (25% of the gross value exc. P&P – at the prevailing price at time of purchase). The customer must pay any and all carriage charges. No returns of discontinued products, unless within 14 days of purchase. This policy does not affect your statutory rights and does not refer to faulty goods.

R&G

Unit 1, Shelley's Lane, East Worldham, Alton, Hampshire, GU34 3AQ
Tel: +44 (0)1420 89007 Fax: +44 (0)1420 87301 www.rg-racing.com Email: info@rg-racing.com