



**FITTING INSTRUCTIONS FOR CG0021 STAINLESS STEEL CHAIN GUARD
FOR YAMAHA XTZ 700 (TENERE) 2019-**



PICTURE A

THIS KIT CONTAINS THE ITEMS PICTURED AND LABELLED OVER PAGE.

SOME PARTS MAY BE SHOWN FOR CLARITY OF INSTRUCTIONS ONLY.

DO NOT PROCEED UNTIL YOU ARE SURE ALL PARTS ARE PRESENT.

PLEASE READ ALL INSTRUCTIONS BEFORE PROCEEDING.

**IF IN ANY DOUBT WHEN FITTING OUR PRODUCTS, CONSULT ONE OF
OUR DEALERS OR HAVE FITTED BY A QUALIFIED TECHNICIAN.**

PLEASE NOTE THAT THE WAY THE KIT IS PACKED DOES NOT NECESSARILY REPRESENT THE
WAY OF MOUNTING TO THE BIKE.

IN THE EVENT OF RUBBER WASHERS BEING USED TO HOLD COMPONENTS ONTO BOLTS,
THESE RUBBER WASHERS CAN BE THROWN AWAY.

DIGITAL COPIES OF THESE INSTRUCTIONS ARE AVAILABLE FROM:

WWW.RG-RACING.COM



| <u>TOOLS REQUIRED</u> | <u>GENERAL TORQUE SETTINGS</u> |
|---|--|
| <ul style="list-style-type: none"> • Set of Metric Allen Keys to include 3 and 4mm A/F. <ul style="list-style-type: none"> • Small amount of super-glue. | <p>M4 BOLT = 8Nm M5 BOLT = 12Nm M6 BOLT = 15Nm M8 BOLT = 20Nm M10 BOLT = 40Nm M12 BOLT = 40Nm</p> |

LEGEND

| ITEM NO. | DESCRIPTION | QTY |
|-----------------|--|------------|
| ITEM 1 | BRUSHED STAINLESS CHAIN GUARD (SMW0167) | 1 |
| ITEM 2 | M5 WASHERS | 1 |
| ITEM 3 | M5 x 10mm LONG BUTTON HEAD BOLT | 1 |
| ITEM 4 | 500mm LENGTH OF RUBBER SEAL SECTION (SRS002) | 1 |
| ITEM 5 | M6 WASHERS | 2 |
| ITEM 6 | M6 x 12mm LONG BUTTON HEAD BOLTS | 2 |

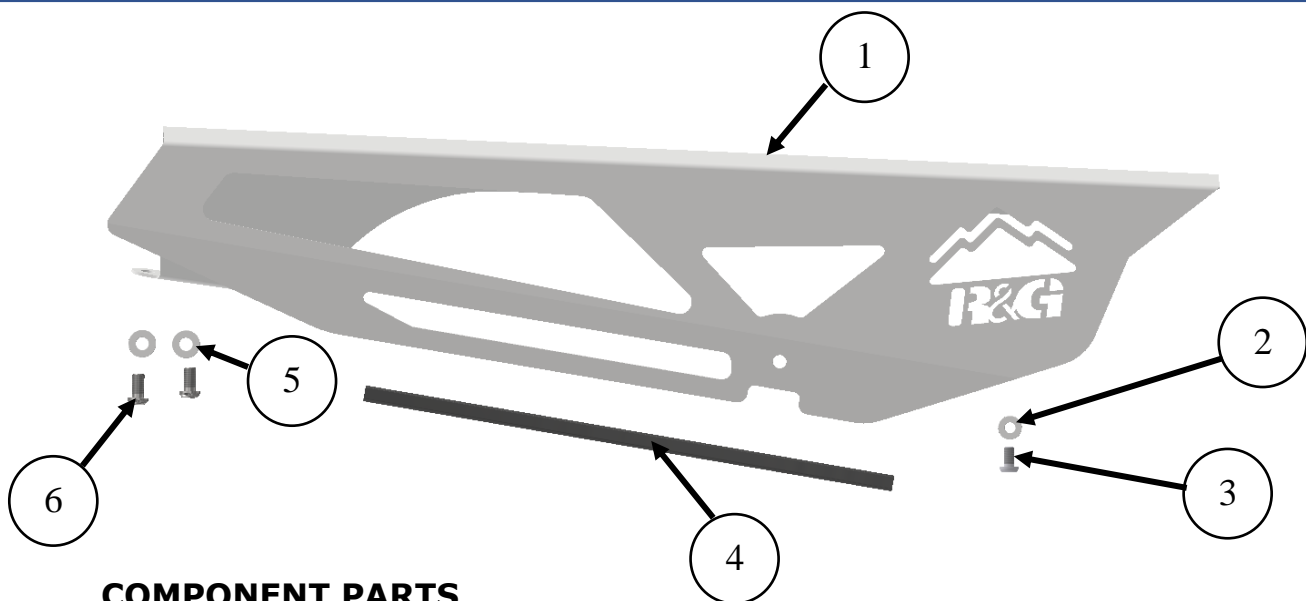

COMPONENT PARTS



PICTURE 1

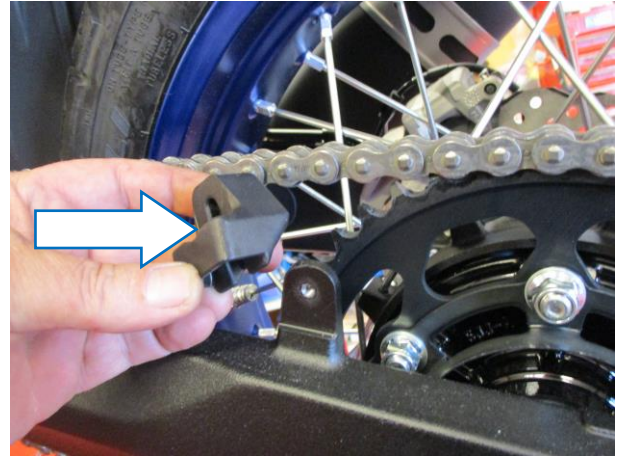

PICTURE 2

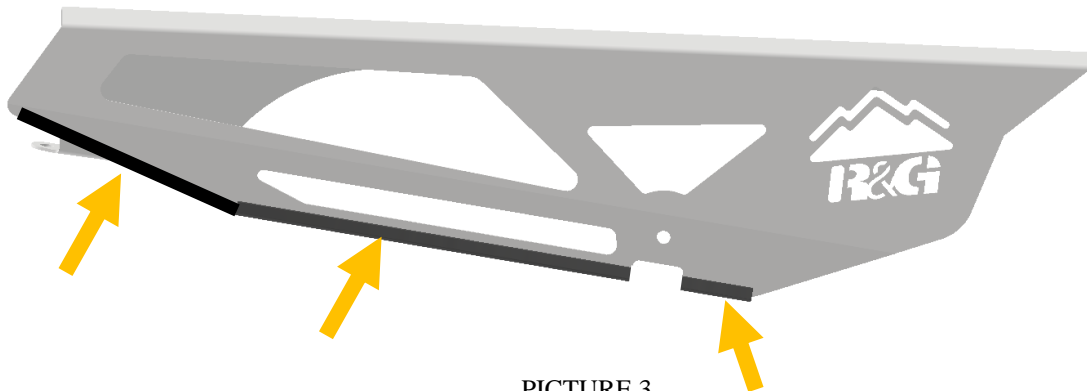

PICTURE 3

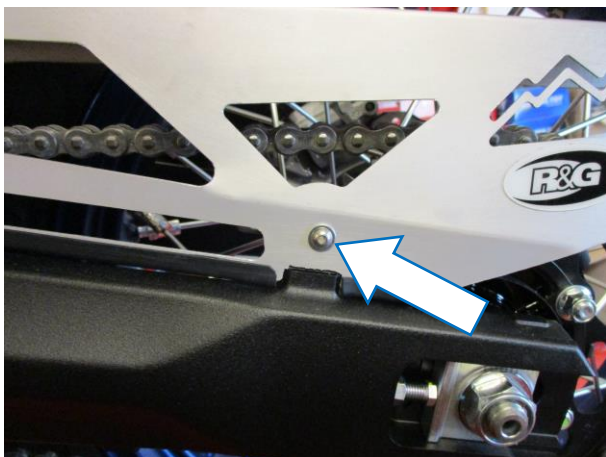

PICTURE 4

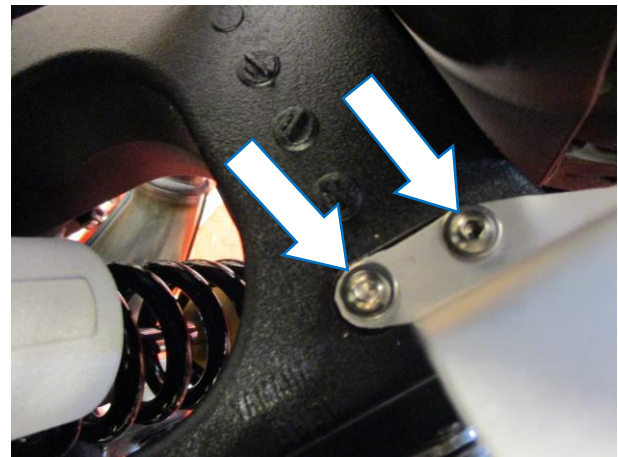

PICTURE 5



FITTING INSTRUCTIONS

- Remove the three bolts in positions arrowed in **picture 1** (positions also shown in **pictures 4 and 5**) then remove the original chain guard.
- Remove the rubber mounting bush arrowed in **picture 2**.
- Cut and stick the rubber seal section (**item 4**) to the chainguard (**item 1**) as shown in **picture 3**.
- Offer the chain guard into position shown in **picture A** and secure using the M5 bolt and washer (**items 2 and 3**) as shown in **picture 4**.
- Secure the forward mounts using the two M6 bolts and washers (**items 5 and 6**) as shown in **picture 5**.
- Please check chain clearance before riding the motorcycle.

ISSUE 1 06/12/2019 (NSY)

CONSUMER NOTICE

The catalogue description and any exhibition of samples are only broad indications of the Products and R&G may make design changes which do not diminish their performance or visual appeal and supplying them in such state shall conform to the order. The Buyer acknowledges no representation or warranty (other than as to title) has been given or will apply to the Products other than those in R&G's order or confirmation and the Buyer confirms it has chosen the Products as being of merchantable quality and suitable for its particular purposes. Where R&G fits the Products or undertakes other services it shall exercise reasonable skill and care and rectify any fault free of charge unless the workmanship has been disturbed. The Buyer is responsible for ensuring that the warranty on the motorcycle is not affected by the fitting of the Products. On return of any defective Products R&G shall at its option either supply a replacement or refund the purchase money but shall not be liable if the Products have been modified or used or maintained otherwise than in accordance with R&G's or manufacturer's instructions and good engineering practice or if the defect arises from accident or neglect. Other than identified above and subject to R&G not limiting its liability for causing death and personal injury, it shall not be liable for indirect or consequential loss and otherwise its liability shall be limited to the amounts paid by the Buyer for the Products or the fitting or service concerned. These terms do not affect the Buyer's statutory rights.

R&G RETURNS POLICY (NON-FAULTY GOODS)

Returns must be pre-authorized (if not pre-authorized the return will be rejected). Goods may only be returned direct to us if they were purchased direct from us (customer must prove if necessary). Otherwise to be returned to original vendor. Goods must be in re-sellable condition, in the opinion of R&G. All returns are subject to a 25% restocking and handling fee (25% of the gross value exc. P&P - at the prevailing price at time of purchase). The customer must pay any and all carriage charges. No returns of discontinued products, unless within 14 days of purchase. This policy does not affect your statutory rights and does not refer to faulty goods.

R&G

Unit 1, Shelley's Lane, East Worldham, Alton, Hampshire, GU34 3AQ
Tel: +44 (0)1420 89007 Fax: +44 (0)1420 87301 www.rg-racing.com Email: info@rg-racing.com



NOTICE DE MONTAGE
CG0021 PROTECTION CHAINE
POUR YAMAHA XTZ 700 (TENERE) 2019-



PHOTO A

LE KIT CONTIENT LES ARTICLES EN PHOTO ET ETIQUETTES SUR LA PAGE
LES PARTIES PRESENTÉES PEUVENT ETRE UNIQUEMENT REPRESENTATIVES POUR LA
CLARTE DES INSTRUCTIONS

NE PAS PROCEDER AU MONTAGE AVANT DE VOUS ETRES ASSURE QUE TOUTES LES PIECES
SOIENT PRESENTES.

SVP, LIRE L'ENSEMBLE DE LA NOTICE AVANT DE PROCEDER AU MONTAGE.
EN CAS DE DOUTE LORS DU MONTAGE, CONSULTEZ UN DE NOS REVENDEURS,
OU FAITES EFFECTUER LE MONTAGE PAR UN TECHNICIEN QUALIFIE.

LA FAÇON DONT LE KIT EST EMBALLE NE CORRESPOND PAS FORCEMENT A LA FAÇON DE
MONTER LES PIECES SUR LA MOTO.

NOTEZ QUE SI LES KITS SONT EMBALLES AVEC DES RONDELLES EN CAOUTCHOUC
SERVANT A TENIR LES COMPOSANTS, CES RONDELLES DOIVENT ETRE JETÉES.

NOTICE DISPONIBLE AU TELECHARGEMENT SUR :
WWW.RG-RACING.COM



| <u>OUTILS REQUIS</u> | <u>VALEURS DE SERRAGE</u> |
|---|---|
| <ul style="list-style-type: none"> • Clés Allen 3 et 4mm. • Un peu de super-glue. | M4 BOULON = 8NM M5 BOULON = 12NM M6 BOULON = 15NM M8 BOULON = 20NM M10 BOULON = 40NM M12 BOULON = 40NM |

LEGENDE

| ARTICLE NO. | DESCRIPTION | QTE |
|--------------------|-----------------------------------|------------|
| ARTICLE 1 | PROTECTION CHAINE (SMW0167) | 1 |
| ARTICLE 2 | M5 RONDELLES | 1 |
| ARTICLE 3 | M5 x 10mm BOULON | 1 |
| ARTICLE 4 | 500mm JOINT D'ETANCHEITE (SRS002) | 1 |
| ARTICLE 5 | M6 RONDELLES | 2 |
| ARTICLE 6 | M6 x 12mm BOULONS | 2 |



NOTICE DE MONTAGE

- Retirez les trois boulons fléchés sur la photo 1 (positions également montrées sur les photos 4 et 5) puis retirez la protection chaîne d'origine.
- Retirez la bague de montage en caoutchouc indiquée sur la photo 2.
- Coupez et collez la section du joint en caoutchouc (article 4) sur le protège-chaîne (article 1) comme indiqué sur la photo 3.
- Placez le protège-chaîne dans la position indiquée sur la photo A et fixez-le à l'aide du boulon M5 et de la rondelle (articles 2 et 3) comme indiqué sur la photo 4.
- Fixez les supports avant à l'aide des deux boulons et rondelles M6 (articles 5 et 6) comme indiqué sur la photo 5.
- Veuillez vérifier le jeu de la chaîne avant d'utiliser la moto.

ISSUE 1 06/12/2019 (NSY)



**MONTAGEANLEITUNG FÜR CG0021 KETTENSCHUTZ AUS EDELSTAHL
FÜR YAMAHA XTZ 700 (TENERE) 2019-**



ABBILDUNG A

ALLE KIT-TEILE SIND AUF DEN NÄCHSTEN SEITEN ABGEBILDET UND GEKENNZEICHNET.

DIE ABGEBILDETEN TEILE DIENEN LEDIGLICH ZUR ERKLÄRUNG.

ÜBERPRÜFEN SIE ZUERST, DASS ALLE TEILE VORHANDEN SIND.

LESEN SIE DIE MONTAGEANLEITUNG KOMPLETT DURCH, BEVOR SIE ANFANGEN.

**WENN SIE BEI DER MONTAGE DIESES PRODUKTES UNSICHER SIND,
BITTE EINEN UNSERER HÄNDLER KONTAKTIEREN ODER DAS KIT VON
EINEM QUALIFIZIERTEN ZWEIRAD-MECHANIKER MONTIEREN LASSEN.**

DIE VERPACKUNG DER TEILE STELLT NICHT DIE REIHENFOLGE DER MONTAGE DAR.

HINWEIS FÜR KITS MIT PLASTIKUNTERLEGSCHLEIBEN AN DEN SCHRAUBEN –
DIESE PLASTIK-UNTERLEGSCHLEIBEN WERDEN NICHT FÜR DEN EINBAU BENÖTIGT!

**EINE DIGITALE VERSION DIESER MONTAGEANLEITUNG KANN AUF
FOLGENDER SEITE HERUNTERGELADEN WERDEN:**

WWW.RG-RACING.COM



| | |
|---|---|
| <p><u>SIE BENÖTIGEN FOLGENDES WERKZEUG</u></p> <ul style="list-style-type: none"> • Satz Inbusschlüssel inkl. 3 und 4mm A/F. <ul style="list-style-type: none"> • Kleine Menge Sekundenkleber | <p><u>GENERAL TORQUE SETTINGS</u></p> <p>M4 SCHRAUBE = 8Nm M5 SCHRAUBE = 12Nm M6 SCHRAUBE = 15Nm M8 SCHRAUBE = 20Nm M10 SCHRAUBE = 40Nm M12 SCHRAUBE = 40Nm</p> |
|---|---|

LIEFERUMFANG

| ARTIKEL-NR. | BESCHREIBUNG | MENGE |
|--------------------|--------------------------------------|--------------|
| ARTIKEL 1 | KETTENSCHUTZ AUS EDELSTAHL (SMW0167) | 1 |
| ARTIKEL 2 | M5 UNTERLEGSCHEIBE | 1 |
| ARTIKEL 3 | M5 x 10mm INBUSSCHRAUBE | 1 |
| ARTIKEL 4 | 500mm KANTENSCHUTZ (SRS002) | 1 |
| ARTIKEL 5 | M6 UNTERLEGSCHEIBE | 2 |
| ARTIKEL 6 | M6 x 12mm INBUSSCHRAUBE | 2 |



MONTAGEANLEITUNG

- Entfernen Sie die drei Schrauben, die in **Abbildung 1** mit Pfeilen gekennzeichnet sind (diese sind auch in den **Abbildungen 4 und 5 abgebildet**), dann entfernen Sie den original Kettenschutz.
- Entfernen Sie das Montageteil, das in **Abbildung 2** gekennzeichnet ist.
- Den Kantenschutz (**Artikel 4**) schneiden und am Kettenschutz (**Artikel 1**) montieren wie in **Abbildung 3** abgebildet.
- Den Kettenschutz in Position bringen (siehe **Abbildung A**) und mit der M5 Schraube und Unterlegscheibe (**Artikel 2 und 3**) befestigen wie in **Abbildung 4** abgebildet.
- Die vorderen Halterungen mit zwei M6 Schrauben und Unterlegscheiben (**Artikel 5 und 6**) befestigen wie in **Abbildung 5 abgebildet**.
- Überprüfen Sie, dass der Kettenschutz nicht von der Kette berührt wird, bevor Sie mit dem Motorrad fahren.

AUSGABE 1 06/12/2019 (NSY)