



## **FITTING INSTRUCTIONS FOR CP0581 CRASH PROTECTORS**



**THIS KIT CONTAINS THE ITEMS PICTURED AND LABELLED OVER PAGE.**

SOME PARTS MAY BE SHOWN FOR CLARITY OF INSTRUCTIONS ONLY.

DO NOT PROCEED UNTIL YOU ARE SURE ALL PARTS ARE PRESENT.

**PLEASE READ ALL INSTRUCTIONS BEFORE PROCEEDING.**

**IF IN ANY DOUBT WHEN FITTING OUR PRODUCTS, CONSULT ONE OF OUR DEALERS  
OR HAVE FITTED BY A QUALIFIED TECHNICIAN.**

PLEASE NOTE THAT THE WAY THE KIT IS PACKED DOES NOT NECESSARILY REPRESENT THE WAY OF  
MOUNTING TO THE BIKE.

IN THE EVENT OF RUBBER WASHERS BEING USED TO HOLD COMPONENTS ONTO BOLTS,  
THESE RUBBER WASHERS CAN BE THROWN AWAY.

**DIGITAL COPIES OF THESE INSTRUCTIONS ARE AVAILABLE FROM:**

[WWW.RG-RACING.COM](http://WWW.RG-RACING.COM)

R&G

Unit 1, Shelley's Lane, East Worldham, Alton, Hampshire, GU34 3AQ  
Tel: +44 (0)1420 89007 [www.rg-racing.com](http://www.rg-racing.com) Email: [info@rg-racing.com](mailto:info@rg-racing.com)

**GENERAL TORQUE SETTINGS**

M4 BOLT = 8Nm  
 M5 BOLT = 12Nm  
 M6 BOLT = 15Nm  
 M8 BOLT = 20Nm  
 M10 BOLT = 40Nm

**TOOLS REQUIRED**

- Torque Wrench
- Scissor Jack
- 14, 17mm & 19mm Sockets and Ratchet

**LEGEND**

ITEM NO.	DESCRIPTION	QTY
ITEM 1	B0061 M10 CRASH PROTECTOR	2
ITEM 2	BC0002 - CRASH PROTECTOR CAP	2
ITEM 3	M10X1.50X110 - HEX ENGINE BOLT - LHS	1
ITEM 4	M10X1.50X130 HEX - HEX ENGINE BOLT - RHS	1
ITEM 5	S1556 - 32MM SPACER LHS	1
ITEM 6	S1557 - 37MM SPACER RHS	1
ITEM 7	S0293 RHS - 5MM	1
ITEM 8	M10X20 O/D - WASHER	2
ITEM 9	LW0001 - LOCKING WASHER	2

**AERO STYLE CRASH-PROTECTOR ORIENTATION**

R&amp;G

Unit 1, Shelley's Lane, East Worldham, Alton, Hampshire, GU34 3AQ  
 Tel: +44 (0)1420 89007 [www.rg-racing.com](http://www.rg-racing.com) Email: [info@rg-racing.com](mailto:info@rg-racing.com)



**LHS ASSEMBLY**

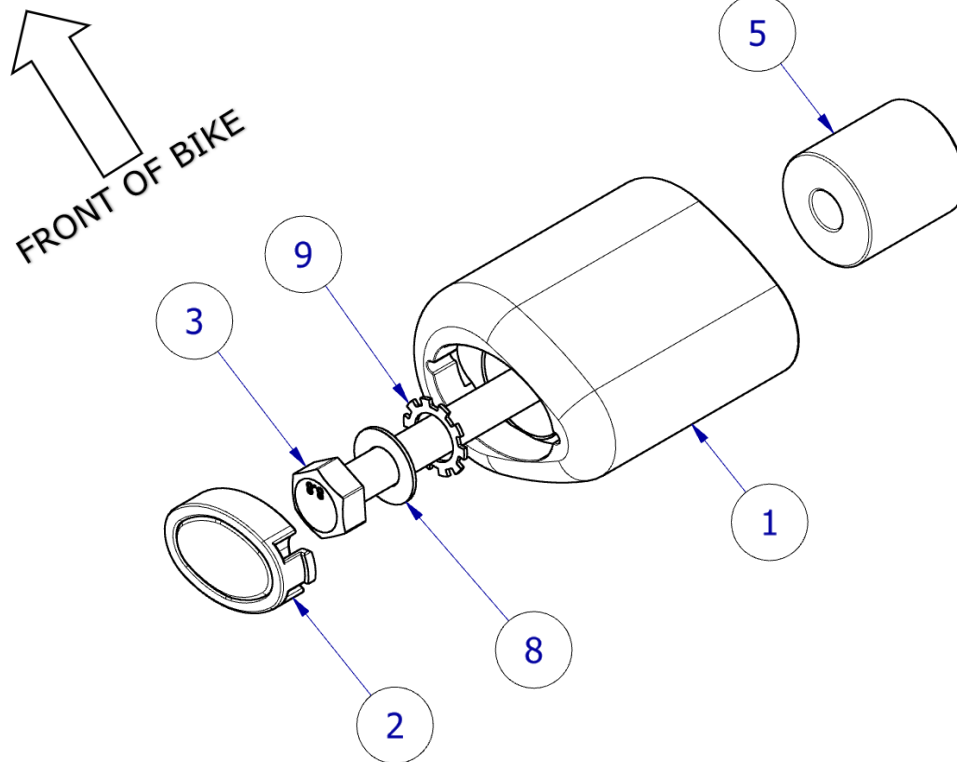

**RHS ASSEMBLY**

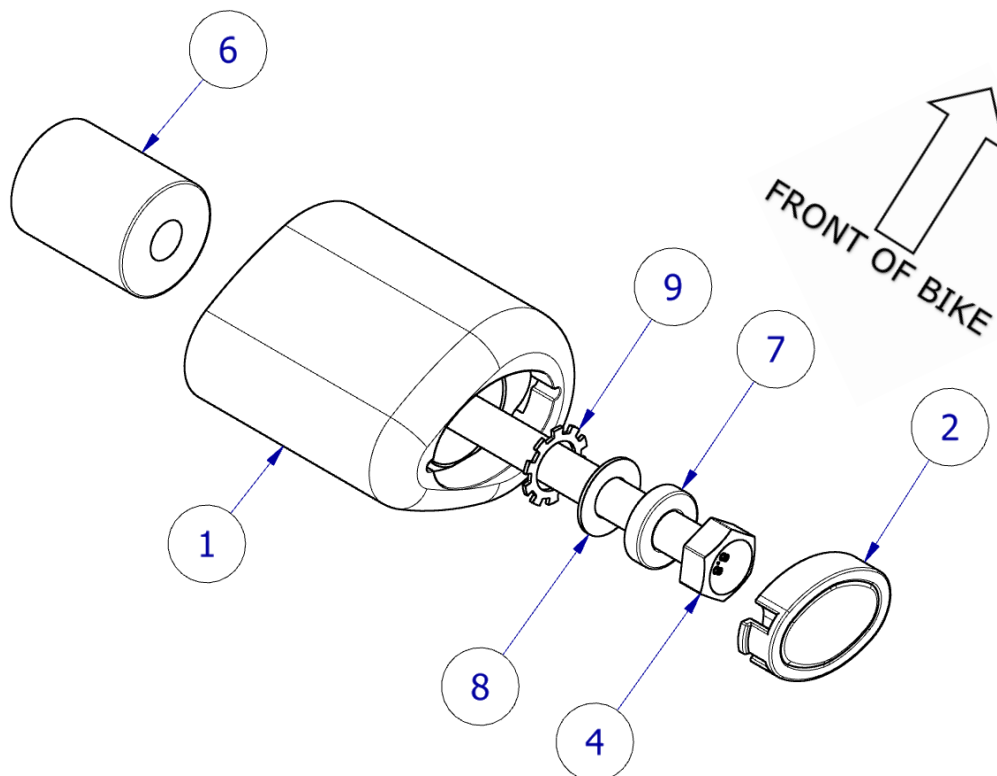



## FITTING IMAGES



PICTURE 1



PICTURE 2

## FITTING INSTRUCTIONS

**IMPORTANT: Before removing engine bolts, ensure the bike is upright and supported by a suitable engine stand or jack placed under the sump of the motorbike to support the partial weight of the engine, this will prevent the engine from moving during fitting. DO NOT REMOVE MORE THAN ONE ENGINE BOLT AT ANY TIME.**

### Left-Hand Side

- Remove the LHS engine bolt shown in **picture 1**. Also remove the OEM 4mm spacer under the bolt head as this will not be needed for reassembly.
- Assemble the LHS crash protector assembly according to the assembly diagram on page 3. Ensure to use the correct spacer (Item 5) for the LHS.
- Fix the crash protector into the exposed engine mount and torque to the recommended specification. **PLEASE NOTE, THE CRASH PROTECTOR MUST BE POSITIONED AS IN THE DIAGRAM ON PAGE 2, WITH THE LARGER END TOWARDS THE FRONT OF THE BIKE.**

### Right-Hand Side

- Moving to the RHS of the motorcycle, remove the engine bolt arrowed in **picture 2**. Also remove the OEM 4mm spacer under the bolt head as this will not be needed for reassembly.
- Assemble the RHS crash protector according to the assembly diagram on page 3. Ensure to place the 5mm spacer (item 7) under the bolt head as this is essential for the correct thread engagement when fitting.

R&G

Unit 1, Shelley's Lane, East Worldham, Alton, Hampshire, GU34 3AQ  
Tel: +44 (0)1420 89007 [www.rg-racing.com](http://www.rg-racing.com) Email: [info@rg-racing.com](mailto:info@rg-racing.com)



- Fix the crash protector into the frame and engine and tighten to the recommended torque. **PLEASE NOTE, THE CRASH PROTECTOR MUST BE POSITIONED AS IN THE DIAGRAM ON PAGE 2, WITH THE LARGER END TOWARDS THE FRONT OF THE BIKE.**

### **Both-Sides**

- Finally, fit the bobbin caps (item 2) to both crash protectors, as shown in **picture 5**.
- Before riding, check both sides are secure, and the crash protectors cannot rotate.
- Check tightness of each side regularly.

ISSUE 1 - 23/09/2024 - DM

### **CONSUMER NOTICE**

The catalogue description and any exhibition of samples are only broad indications of the Products and R&G may make design changes which do not diminish their performance or visual appeal and supplying them in such state shall conform to the order. The Buyer acknowledges no representation or warranty (other than as to title) has been given or will apply to the Products other than those in R&G's order or confirmation and the Buyer confirms it has chosen the Products as being of merchantable quality and suitable for its particular purposes. Where R&G fits the Products or undertakes other services it shall exercise reasonable skill and care and rectify any fault free of charge unless the workmanship has been disturbed. The Buyer is responsible for ensuring that the warranty on the motorcycle is not affected by the fitting of the Products. On return of any defective Products R&G shall at its option either supply a replacement or refund the purchase money but shall not be liable if the Products have been modified or used or maintained otherwise than in accordance with R&G's or manufacturer's instructions and good engineering practice or if the defect arises from accident or neglect. Other than identified above and subject to R&G not limiting its liability for causing death and personal injury, it shall not be liable for indirect or consequential loss and otherwise its liability shall be limited to the amounts paid by the Buyer for the Products or the fitting or service concerned. These terms do not affect the Buyer's statutory rights.

### **R&G RACING RETURNS POLICY (NON-FAULTY GOODS)**

Returns must be pre-authorized (if not pre-authorized the return will be rejected). Goods may only be returned direct to us if they were purchased direct from us (customer must prove if necessary). Otherwise to be returned to original vendor. Goods must be in re-sellable condition, in the opinion of R&G Racing. All returns are subject to a 25% restocking and handling fee (25% of the gross value exc. P&P – at the prevailing price at time of purchase). The customer must pay any and all carriage charges. No returns of discontinued products, unless within 14 days of purchase. This policy does not affect your statutory rights and does not refer to faulty goods.

R&G

Unit 1, Shelley's Lane, East Worldham, Alton, Hampshire, GU34 3AQ  
Tel: +44 (0)1420 89007 [www.rg-racing.com](http://www.rg-racing.com) Email: [info@rg-racing.com](mailto:info@rg-racing.com)





## **NOTICE DE MONTAGE CP0581 PROTECTIONS CRASH**



**CE KIT CONTIENT LES ARTICLES ILLUSTRÉS ET ÉTIQUETÉS SUR LA PAGE.**

CERTAINES PARTIES PEUVENT ÊTRE PRÉSENTES UNIQUEMENT POUR LA CLARTÉ DES INSTRUCTIONS.

NE PAS PROCÉDER AU MONTAGE TANT QUE VOUS N'ÊTES PAS SÛR QUE TOUTES LES PIÈCES SOIENT PRÉSENTES.

**VEUILLEZ LIRE TOUTES LES INSTRUCTIONS AVANT DE CONTINUER.**

**EN CAS DE DOUTE LORS DU MONTAGE DE NOS PRODUITS, CONSULTEZ UN DE NOS REVENEURS OU FAITES APPEL À UN TECHNICIEN QUALIFIÉ.**

VEUILLEZ NOTER QUE LA FAÇON DONT LE KIT EST EMBALLÉ NE REPRÉSENTE PAS NECESSAIREMENT LA MANIÈRE DE LE MONTER SUR LA MOTO.

SI DES RONDELLES EN CAOUTCHOUC SONT UTILISÉES POUR MAINTENIR LES COMPOSANTS SUR LES BOULONS, ELLES PEUVENT ÊTRE JETÉES.

**NOTICE DISPONIBLE AU TÉLÉCHARGEMENT SUR :**

R&G  
Unit 1, Shelley's Lane, East Worldham, Alton, Hampshire, GU34 3AQ  
Tel: +44 (0)1420 89007 [www.rg-racing.com](http://www.rg-racing.com) Email: [info@rg-racing.com](mailto:info@rg-racing.com)



<b><u>VALEURS DE SERRAGE</u></b>	<b><u>OUTILS REQUIS</u></b>
M4 BOULON = 8Nm	<ul style="list-style-type: none"> <li>• Clé dynamométrique</li> <li>• Cric à ciseaux</li> <li>• Douilles et cliquet 14, 17 mm et 19 mm</li> </ul>
M5 BOULON = 12Nm	
M6 BOULON = 15Nm	
M8 BOULON = 20Nm	
M10 BOULON = 40Nm	

### **LÉGENDE**

<b>ARTICLE NO.</b>	<b>DESCRIPTION</b>	<b>QTÉ</b>
ARTICLE 1	B0061 M10 PROTECTION CRASH	2
ARTICLE 2	BC0002 - CAPUCHON DE PROTECTION CRASH	2
ARTICLE 3	M10X1.50X110 - BOULON CÔTÉ GAUCHE	1
ARTICLE 4	M10X1.50X130 BOULON CÔTÉ DROIT	1
ARTICLE 5	S1556 - 32MM ENTRETROISE CÔTÉ GAUCHE	1
ARTICLE 6	S1557 - 37MM ENTRETROISE CÔTÉ DROIT	1
ARTICLE 7	S0293 DROITE - 5MM	1
ARTICLE 8	M10X20 O/D - RONDELLE	2
ARTICLE 9	LW0001 - RONDELLE DE BLOCAGE	2

### **ORIENTATION DE LA PROTECTION CRASH**



R&amp;G

Unit 1, Shelley's Lane, East Worldham, Alton, Hampshire, GU34 3AQ  
 Tel: +44 (0)1420 89007 [www.rg-racing.com](http://www.rg-racing.com) Email: [info@rg-racing.com](mailto:info@rg-racing.com)



**ASSEMBLAGE CÔTÉ GAUCHE**

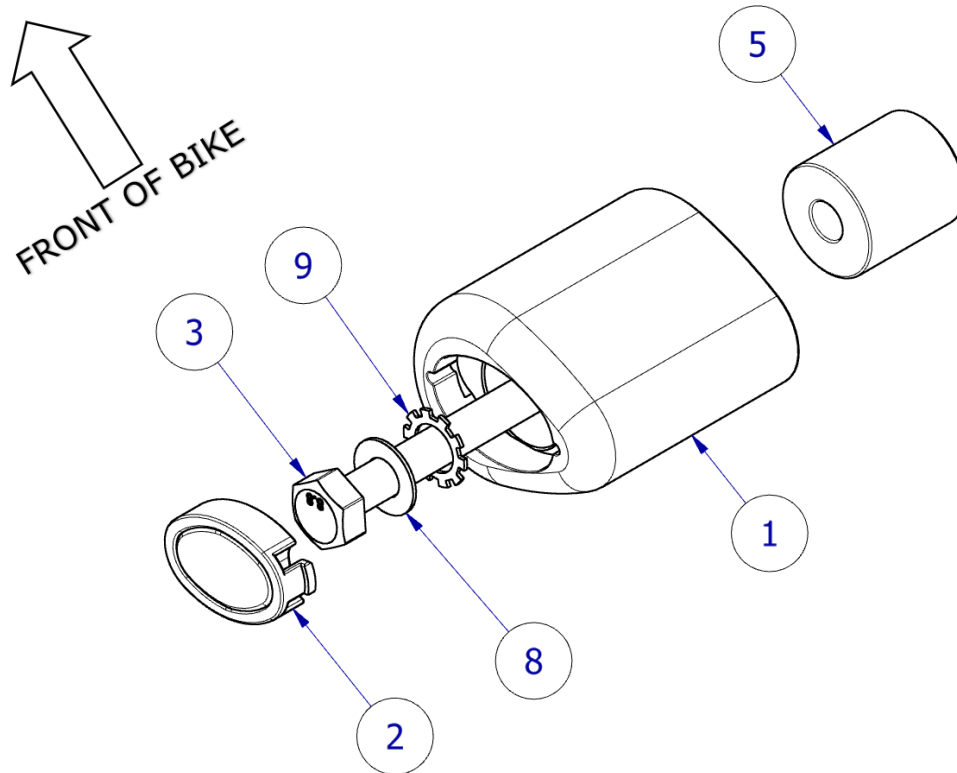

**ASSEMBLAGE CÔTÉ DROIT**

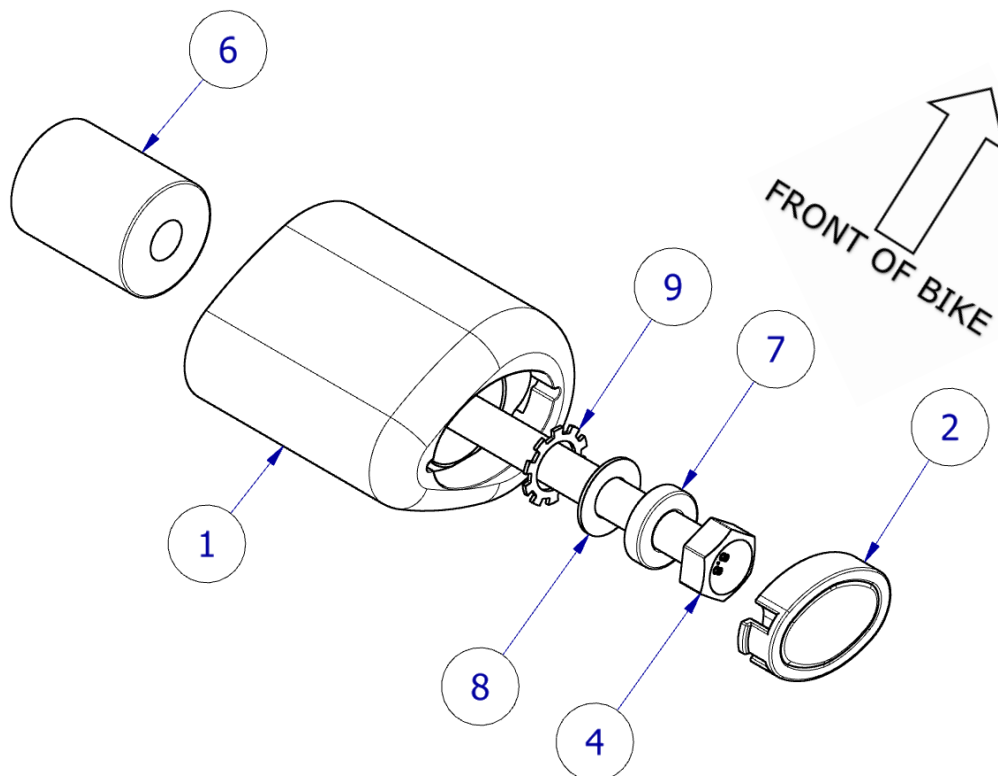





## IMAGES DE MONTAGE



PHOTO 1



PHOTO 2

## NOTICE DE MONTAGE

**IMPORTANT: Avant de retirer les boulons du moteur, assurez-vous que la moto soit en position verticale et soutenue par un support moteur ou un cric approprié placé sous le carter de la moto pour supporter le poids partiel du moteur, cela empêchera le moteur de bouger pendant le montage. NE RETIREZ PAS PLUS D'UN BOULON DU MOTEUR À LA FOIS.**

### Côté gauche

- Retirez le boulon moteur gauche illustré sur la photo 1. Retirez également l'entretoise d'origine de 4 mm sous la tête du boulon, car elle ne sera pas nécessaire pour le remontage.
- Assemblez l'ensemble de protection crash gauche conformément au schéma de montage de la page 3. Assurez-vous d'utiliser l'entretoise appropriée (article 5) pour le côté gauche.
- Fixez la protection crash dans le support moteur exposé et serrez au couple recommandé. VEUILLEZ NOTER QUE LA PROTECTION CRASH DOIT ÊTRE POSITIONNÉE COMME SUR LE SCHÉMA DE LA PAGE 2, AVEC L'EXTRÉMITÉ LA PLUS GRANDE VERS L'AVANT DE LA MOTO.

### Côté droit

- En passant du côté droit de la moto, retirez le boulon du moteur indiqué par une flèche sur la photo 2. Retirez également l'entretoise d'origine de 4 mm sous la tête du boulon, car elle ne sera pas nécessaire pour le remontage.
- Assemblez la protection crash côté droit conformément au schéma de montage de la page 3. Assurez-vous de placer l'entretoise de 5 mm (article 7) sous la tête du boulon, car elle est essentielle pour l'engagement correct du filetage lors du montage.

R&amp;G

Unit 1, Shelley's Lane, East Worldham, Alton, Hampshire, GU34 3AQ  
 Tel: +44 (0)1420 89007 Fax: [www.rg-racing.com](http://www.rg-racing.com) Email: [info@rg-racing.com](mailto:info@rg-racing.com)



- Fixez la protection crash au cadre et au moteur et serrez au couple recommandé. VEUILLEZ NOTER QUE LA PROTECTION CRASH DOIT ÊTRE POSITIONNÉE COMME SUR LE SCHÉMA DE LA PAGE 2, AVEC L'EXTRÉMITÉ LA PLUS GRANDE VERS L'AVANT DU MOTO.

### **Les 2 Côtés**

- Enfin, installez les capuchons de protection (article 2) sur les deux protections crash, comme indiqué sur la photo 5.
- Avant de rouler, vérifiez que les deux côtés soient bien fixés et que les protections crash ne puissent pas tourner.
- Vérifiez régulièrement le serrage de chaque côté.

ISSUE 1 – 23/09/2024 – DM

### **CONSUMER NOTICE**

The catalogue description and any exhibition of samples are only broad indications of the Products and R&G may make design changes which do not diminish their performance or visual appeal and supplying them in such state shall conform to the order. The Buyer acknowledges no representation or warranty (other than as to title) has been given or will apply to the Products other than those in R&G's order or confirmation and the Buyer confirms it has chosen the Products as being of merchantable quality and suitable for its particular purposes. Where R&G fits the Products or undertakes other services it shall exercise reasonable skill and care and rectify any fault free of charge unless the workmanship has been disturbed. The Buyer is responsible for ensuring that the warranty on the motorcycle is not affected by the fitting of the Products. On return of any defective Products R&G shall at its option either supply a replacement or refund the purchase money but shall not be liable if the Products have been modified or used or maintained otherwise than in accordance with R&G's or manufacturer's instructions and good engineering practice or if the defect arises from accident or neglect. Other than identified above and subject to R&G not limiting its liability for causing death and personal injury, it shall not be liable for indirect or consequential loss and otherwise its liability shall be limited to the amounts paid by the Buyer for the Products or the fitting or service concerned. These terms do not affect the Buyer's statutory rights.

### **R&G RACING RETURNS POLICY (NON-FAULTY GOODS)**

Returns must be pre-authorised (if not pre-authorised the return will be rejected). Goods may only be returned direct to us if they were purchased direct from us (customer must prove if necessary). Otherwise to be returned to original vendor. Goods must be in re-sellable condition, in the opinion of R&G Racing. All returns are subject to a 25% restocking and handling fee (25% of the gross value exc. P&P – at the prevailing price at time of purchase). The customer must pay any and all carriage charges. No returns of discontinued products, unless within 14 days of purchase. This policy does not affect your statutory rights and does not refer to faulty goods.

R&G

Unit 1, Shelley's Lane, East Worldham, Alton, Hampshire, GU34 3AQ  
Tel: +44 (0)1420 89007 Fax: [www.rg-racing.com](http://www.rg-racing.com) Email: [info@rg-racing.com](mailto:info@rg-racing.com)