

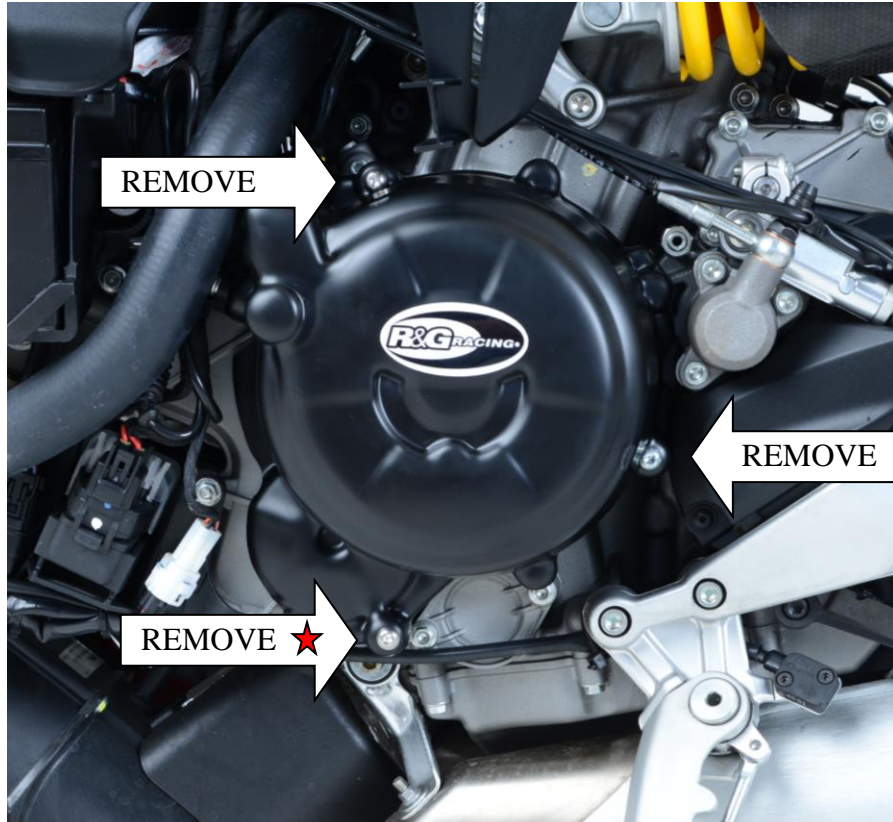

**FITTING INSTRUCTIONS FOR ECC0196 LHS GENERATOR COVER**  
**DUCATI PANIGALE 899 '13-, PANIGALE 959 '16-**



In this kit there should be:

- 1x Engine Case Cover (ECC0196)
- 3x M6 x 35mm Long Button Head Bolts
- 1x M6 Washer

**PLEASE READ THESE INSTRUCTIONS FULLY BEFORE STARTING**

- Please make sure the engine is cold before proceeding with the fitting of the R&G cover.
- Remove the lower fairings from the left side of the bike by removing the row of fairing bolts which attach the lower to the upper fairing, along with the fairing bolts at the rear by the swingarm pivot, the two bolts underneath the bike and the bolt that is accessible on the inside cowling surrounding the lower radiator.
- On the left side of the bike, the upper fairing also needs to be removed. Remove the five fairings bolts along with the push rivet on the inner cowling before gently pulling the fairing out of its locating tabs.



- To fit the R&G engine case cover remove the three M6 engine case bolts in the positions arrowed above. Hold the cover loosely over the case to help identify the correct ones. **DO NOT REMOVE ALL OF THE CASE BOLTS.**
- Offer up the R&G cover to the engine and carefully fit it over the casing. Ensure that the three R&G bolts are lined up with the holes in the engine casing, and then push on as far as it will go.
- Please note the bolts marked with a star in the diagram require washers.
- Fit the bolts through the Engine Case Cover and into the engine case.
- With a 4mm Allen key tighten the bolts equally so that they pull the cover into place. **DO NOT FULLY TIGHTEN.**
- Finally use a torque wrench set at 10 N/m (7 Lb/ft) to fully tighten.
- Re-position the lower fairing and re-fit the mounting bolt.
- It is suggested that you check the tightness of the mounting bolts on a regular basis i.e. when cleaning or once a month.
- NOTE for the cleaning of this product you should only use a soft polishing cloth and a mild general cleaning agent.
- **AVOID HARMFUL CHEMICALS. IF IN DOUBT DO NOT USE AS THEY COULD ALTER THE STRENGTH OF THE COVER.**
- R&G will accept no liability if the above procedure and torque settings are not followed.

ISSUE 1 02/10/2015 (AR)

#### **CONSUMER NOTICE**

The catalogue description and any exhibition of samples are only broad indications of the Products and R&G may make design changes which do not diminish their performance or visual appeal and supplying them in such state shall conform to the order. The Buyer acknowledges no representation or warranty (other than as to title) has been given or will apply to the Products other than those in R&G's order or confirmation and the Buyer confirms it has chosen the Products as being of merchantable quality and suitable for its particular purposes. Where R&G fits the Products or undertakes other services it shall exercise reasonable skill and care and rectify any fault free of charge unless the workmanship has been disturbed. The Buyer is responsible for ensuring that the warranty on the motorcycle is not affected by the fitting of the Products. On return of any defective Products R&G shall at its option either supply a replacement or refund the purchase money but shall not be liable if the Products have been modified or used or maintained otherwise than in accordance with R&G's or manufacturer's instructions and good engineering practice or if the defect arises from accident or neglect. Other than identified above and subject to R&G not limiting its liability for causing death and personal injury, it shall not be liable for indirect or consequential loss and otherwise its liability shall be limited to the amounts paid by the Buyer for the Products or the fitting or service concerned. These terms do not affect the Buyer's statutory rights.

#### **R&G RACING RETURNS POLICY (NON-FAULTY GOODS)**

Returns must be pre-authorized (if not pre-authorized the return will be rejected). Goods may only be returned direct to us if they were purchased direct from us (customer must prove if necessary). Otherwise to be returned to original vendor. Goods must be in re-sellable condition, in the opinion of R&G Racing. All returns are subject to a 25% restocking and handling fee (25% of the gross value exc. P&P – at the prevailing price at time of purchase). The customer must pay any and all carriage charges. No returns of discontinued products, unless within 14 days of purchase. This policy does not affect your statutory rights and does not refer to faulty goods.



**NOTICE DE MONTAGE ECC0196BK PROTECTION MOTEUR COTE GAUCHE**  
**DUCATI PANIGALE 899 '13-, PANIGALE 959 '16-**

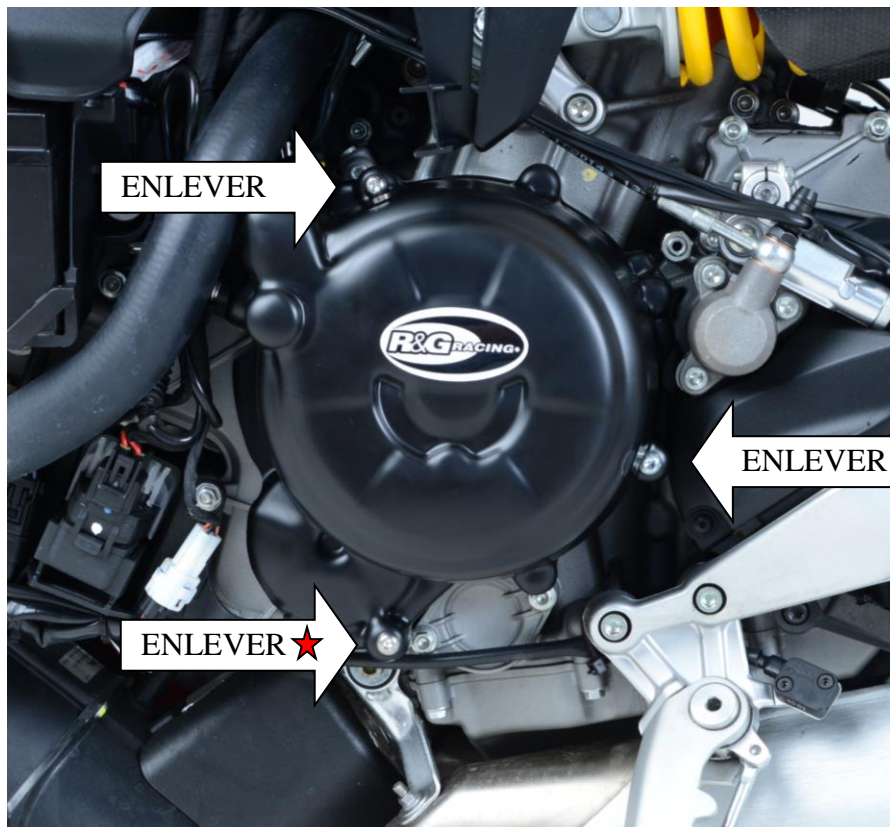

Le kit doit contenir:

- 1x Protection carter moteur (ECC0196)
- 3x M6 x 35mm Boulon
- 1x M6 Rondelle

Bien lire ces instructions avant de procéder au montage :

- Assurez-vous que le moteur soit froid.
- Enlever les carénages inférieurs du côté droit de la moto, en enlevant la rangée de boulons qui fixe la partie inférieure à la partie supérieure, avec les boulons de carénage à l'arrière du pivot de bras oscillant, les 2 boulons sous la moto et le boulon qui est accessible à l'intérieur du capot qui entoure le radiateur inférieur.
- Du côté gauche de la moto, le carénage supérieur doit aussi être enlevé. Enlever les 5 boulons de carénages avec rivet sur le capot interne avant de tirer le carénage vers l'extérieur, en dehors de ses onglets.
- Enlever les 3 boulons M6 dans les positions indiquées ci dessus. Tenir le couvercle autour du carter pour aider à identifier les bons trous. **NE PAS ENLEVER TOUS LES BOULONS DE CARTER.**



- Monter la protection R&G sur le moteur et placez-la soigneusement autour du carter. Veiller à ce que les 3 boulons R&G soient alignés avec les trous dans le carter moteur, puis pousser au maximum.
- Les boulons indiqués par des étoiles sur le schéma nécessitent des rondelles.
- Insérer les boulons dans la protection carter moteur et dans le carter moteur.
- Serrer les boulons avec une clé Allen de 4mm, pour qu'ils placent la protection en place. NE PAS SERRER COMPLETEMENT.
- Utiliser une clé dynamométrique à 10 Nm (7 Lb ft) pour bloquer).
- Nous vous suggérons de vérifier le serrage au moins une fois par mois, lors du nettoyage par exemple.
- NOTE: Pour le nettoyage, vous devriez utiliser uniquement un chiffon doux et un agent nettoyant doux.
- Ne pas utiliser d'agents chimiques qui pourraient altérer l'efficacité de la protection.
- R&G n'acceptera aucune responsabilité en cas de mauvais couple de serrage ou d'utilisation inappropriée d'agents nocifs.

ISSUE 1 02/10/2015 (AR)

#### **CONSUMER NOTICE**

The catalogue description and any exhibition of samples are only broad indications of the Products and R&G may make design changes which do not diminish their performance or visual appeal and supplying them in such state shall conform to the order. The Buyer acknowledges no representation or warranty (other than as to title) has been given or will apply to the Products other than those in R&G's order or confirmation and the Buyer confirms it has chosen the Products as being of merchantable quality and suitable for its particular purposes. Where R&G fits the Products or undertakes other services it shall exercise reasonable skill and care and rectify any fault free of charge unless the workmanship has been disturbed. The Buyer is responsible for ensuring that the warranty on the motorcycle is not affected by the fitting of the Products. On return of any defective Products R&G shall at its option either supply a replacement or refund the purchase money but shall not be liable if the Products have been modified or used or maintained otherwise than in accordance with R&G's or manufacturer's instructions and good engineering practice or if the defect arises from accident or neglect. Other than identified above and subject to R&G not limiting its liability for causing death and personal injury, it shall not be liable for indirect or consequential loss and otherwise its liability shall be limited to the amounts paid by the Buyer for the Products or the fitting or service concerned. These terms do not affect the Buyer's statutory rights.

#### **R&G RACING RETURNS POLICY (NON-FAULTY GOODS)**

Returns must be pre-authorized (if not pre-authorized the return will be rejected). Goods may only be returned direct to us if they were purchased direct from us (customer must prove if necessary). Otherwise to be returned to original vendor. Goods must be in re-sellable condition, in the opinion of R&G Racing. All returns are subject to a 25% restocking and handling fee (25% of the gross value exc. P&P – at the prevailing price at time of purchase). The customer must pay any and all carriage charges. No returns of discontinued products, unless within 14 days of purchase. This policy does not affect your statutory rights and does not refer to faulty goods.