



FP0194

FITTING INSTRUCTIONS FOR FP0194BK FORK PROTECTORS
KAWASAKI Z900 2017-

Page | 1



THE ABOVE PICTURES MAY BE REPRESENTATIVE ONLY

THIS KIT CONTAINS THE ITEMS PICTURED AND LABELLED BELOW.
DO NOT PROCEED UNTIL YOU ARE SURE ALL PARTS ARE PRESENT.

Please note that the way the kit is packed does not necessarily represent the way of mounting to the bike

Please note that in cases where kits are packed with a plastic tube separating components on the spindle bar (this tube should be discarded).

THE PARTS SHOWN MAY BE REPRESENTATIVE ONLY (FOR CLARITY OF INSTRUCTIONS ONLY)

Digital copies of these instructions are available to download from www.rg-racing.com

GENERAL TORQUE SETTINGS

M4 BOLT = 8Nm
M5 BOLT = 12Nm
M6 BOLT = 15Nm
M8 BOLT = 20Nm
M10 BOLT = 40Nm



FP0194

Page | 2

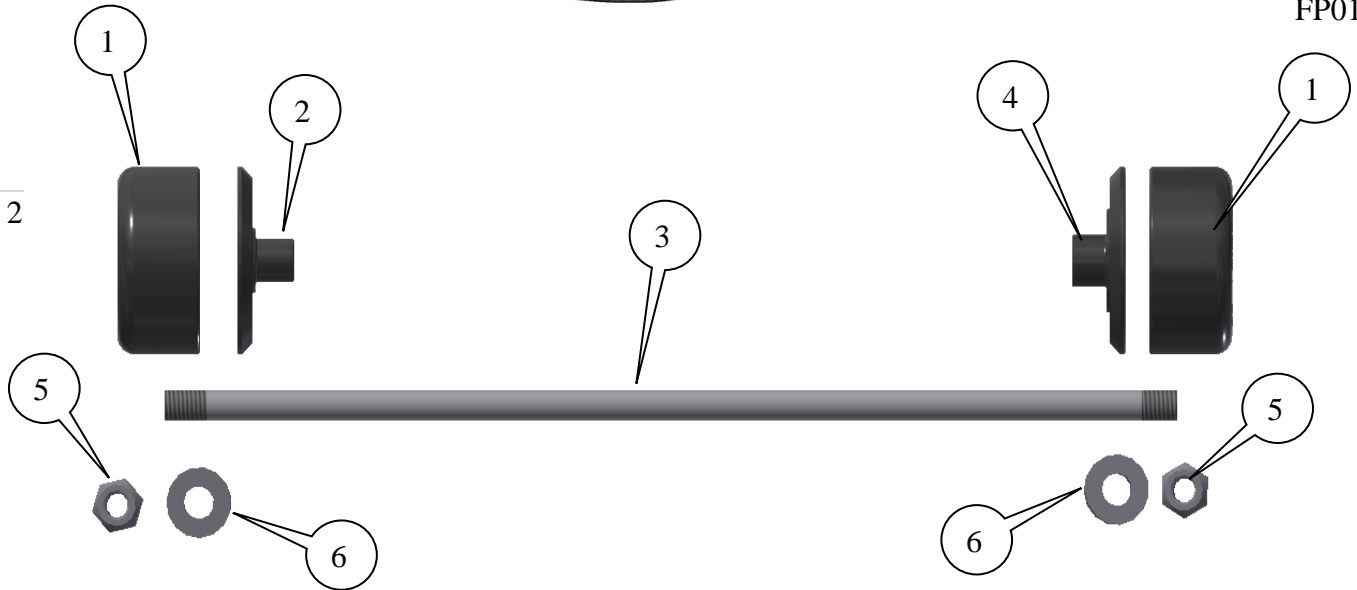

LEGEND

- ITEM 1 = CRASH PROTECTORS (L & R-H-S) (B0442 M8) (x2).
- ITEM 2 = SPACER (L-H-S) (S1006 – 11.5mm LOCATION) (x1).
- ITEM 3 = SPINDLE BAR (SB053 – 293mm LONG) (x1).
- ITEM 4 = SPACER (R-H-S) (S1007 – 13.75mm LOCATION) (x1).
- ITEM 5 = M8 NYLOC NUTS (x2).
- ITEM 6 = M8 WASHERS (x2).

TOOLS REQUIRED

- Socket set to include 2x13mm A/F sockets and wrenches.

Left hand side



Right hand side



FITTING INSTRUCTIONS

- Fit one nut and washer onto the spindle-bar (SB053), engage the nut so the plastic insert of nut is fully engaged.
- Feed spindle-bar with nut and washer through either crash protector (B0442 M8) and through the spacer with the smaller location diameter (S1006), as shown above.
- Place this assembly through the front wheel spindle from the left-hand side (as you sit on the motorcycle), ensuring the spigot end locates into the spindle.
- Place the remaining spacer with the larger location diameter (S1007) over the exposed end of the spindle bar on the right-hand side so that the spigot end locates into the spindle.
- Place the remaining crash protector (B0442 M8) over the exposed end of the spindle bar on the right-hand side.
- Fit the remaining washer and nut from kit onto thread and tighten until both nuts are engaged in nylon and equal amounts protrude from either side (please ensure the logo is located at the top of the crash protector). Do not overtighten – the nyloc nuts will hold it tight.

ISSUE 1 31/03/2017 (NSY)

CONSUMER NOTICE

The catalogue description and any exhibition of samples are only broad indications of the Products and R&G may make design changes which do not diminish their performance or visual appeal and supplying them in such state shall conform to the order. The Buyer acknowledges no representation or warranty (other than as to title) has been given or will apply to the Products other than those in R&G's order or confirmation and the Buyer confirms it has chosen the Products as being of merchantable quality and suitable for its particular purposes. Where R&G fits the Products or undertakes other services it shall exercise reasonable skill and care and rectify any fault free of charge unless the workmanship has been disturbed. The Buyer is responsible for ensuring that the warranty on the motorcycle is not affected by the fitting of the Products. On return of any defective Products R&G shall at its option either supply a replacement or refund the purchase money but shall not be liable if the Products have been modified or used or maintained otherwise than in accordance with R&G's or manufacturer's instructions and good engineering practice or if the defect arises from accident or neglect. Other than identified above and subject to R&G not limiting its liability for causing death and personal injury, it shall not be liable for indirect or consequential loss and otherwise its liability shall be limited to the amounts paid by the Buyer for the Products or the fitting or service concerned. These terms do not affect the Buyer's statutory rights.

R&G RACING RETURNS POLICY (NON-FAULTY GOODS)

Returns must be pre-authorized (if not pre-authorized the return will be rejected). Goods may only be returned direct to us if they were purchased direct from us (customer must prove if necessary). Otherwise to be returned to original vendor. Goods must be in resellable condition, in the opinion of R&G Racing. All returns are subject to a 25% restocking and handling fee (25% of the gross value exc. P&P – at the prevailing price at time of purchase). The customer must pay any and all carriage charges. No returns of discontinued products, unless within 14 days of purchase. This policy does not affect your statutory rights and does not refer to faulty goods.

R&G Racing

Unit 1, Shelley's Lane, East Worldham, Alton, Hampshire, GU34 3AQ

Tel: +44 (0)1420 89007 Fax: +44 (0)1420 87301 www.rg-racing.com Email: info@rg-racing.com



FP0194

NOTICE DE MONTAGE POUR FP0194BK PROTECTIONS FOURCHE
KAWASAKI Z900 2017-

Page | 4



LES PHOTOS CI-DESSUS SONT UNIQUEMENT REPRESENTATIVES

LE KIT CONTIENT LES ARTICLES EXPOSES CI-DESSOUS, VERIFIER QUE TOUTES LES PIECES SOIENT PRESENTES AVANT DE PROCEDER AU MONTAGE.

La façon dont le kit est emballé ne correspond pas forcément à la façon de monter les pièces sur la moto

Notez que si les kits sont emballés avec un tube en plastic qui sépare les composants sur l'axe, ce tube doit être jeté).

LES PARTIES PRESENTEES PEUVENT ETRE UNIQUEMENT REPRESENTATIVES (POUR LA CLARTE DES INSTRUCTIONS UNIQUEMENT)

Notice disponible au téléchargement sur www.rg-racing.com

COUPLES DE SERRAGE RECOMMANDES

M4 BOULON = 8Nm
M5 BOULON = 12Nm
M6 BOULON = 15Nm
M8 BOULON = 20Nm
M10 BOULON = 40Nm



FP0194

Page | 5

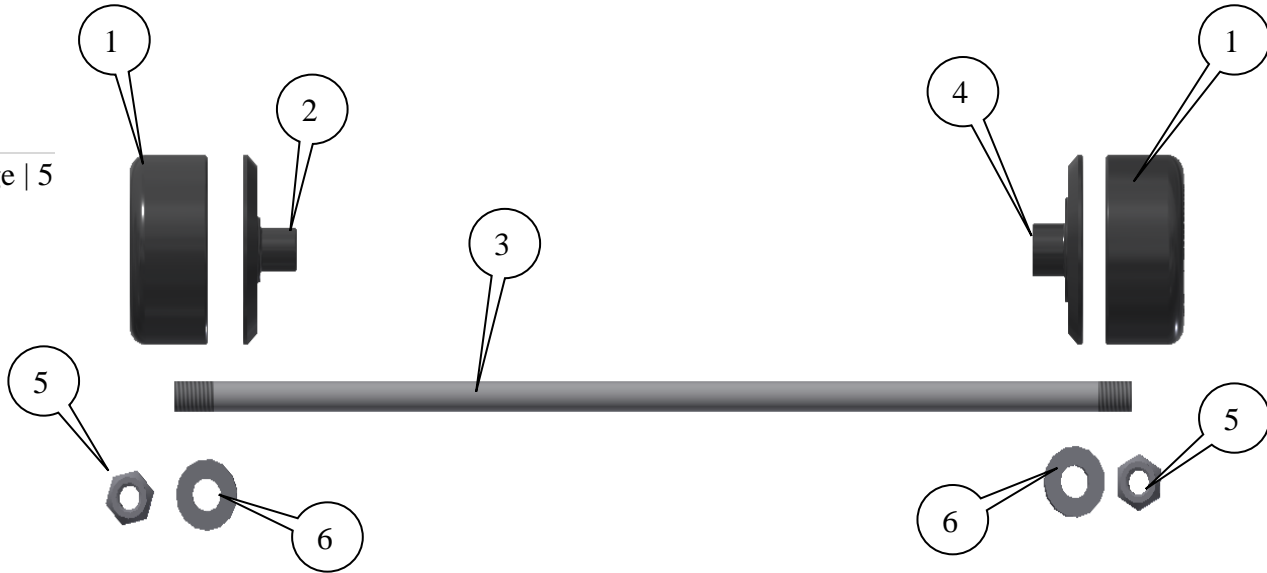

LEGENDE

- ARTICLE 1 = PROTECTIONS CRASH (GAUCHE ET DROITE) (B0442 M8) (x2).
- ARTICLE 2 = ENTRETOISE (GAUCHE) (S1006 – 11.5mm emplacement) (x1).
- ARTICLE 3 = AXE (SB053 – 293mm de long) (x1).
- ARTICLE 4 = ENTRETOISE (DROITE) (S1007 – 13.75mm emplacement) (x1).
- ARTICLE 5 = M8 ECROUS (x2).
- ARTICLE 6 = M8 RONDELLES (x2).

OUTILS REQUIS

- Clé à cliquet + douilles 2x13mm.

Coté gauche



Coté droit



NOTICE DE MONTAGE

- Insérer un écrou et une rondelle sur l'axe (SB053), engager l'écrou de façon à ce que l'insert en plastique de l'écrou soit complètement engagé.
- Passer l'axe avec écrou et rondelle dans la protection crash (B0442 M8) puis dans l'entretoise avec le diamètre le plus petit (S1006), voir ci-dessus.
- Placer cet ensemble dans l'axe de roue avant du côté gauche (lorsqu'on est assis sur la moto), en veillant à ce que l'extrémité du ressort se place dans l'axe.
- Placer l'entretoise restante avec le diamètre le plus large (S1007) sur l'extrémité de l'axe du côté droit de façon à ce que l'extrémité de ressort se place dans l'axe.
- Placer la protection crash restante (B0442 M8) sur l'extrémité de l'axe du côté droit.
- Insérer la rondelle restant et l'écrou du kit sur le filetage puis serrer jusqu'à ce que les 2 écrous soient engagés dans le nylon et que les longueurs dépassantes de chaque côté (Veiller à ce que le logo soit placée sur le haut de la protection). Ne pas trop serrer – les écrous fixent l'ensemble.

ISSUE 1 31/03/2017 (NSY)

CONSUMER NOTICE

The catalogue description and any exhibition of samples are only broad indications of the Products and R&G may make design changes which do not diminish their performance or visual appeal and supplying them in such state shall conform to the order. The Buyer acknowledges no representation or warranty (other than as to title) has been given or will apply to the Products other than those in R&G's order or confirmation and the Buyer confirms it has chosen the Products as being of merchantable quality and suitable for its particular purposes. Where R&G fits the Products or undertakes other services it shall exercise reasonable skill and care and rectify any fault free of charge unless the workmanship has been disturbed. The Buyer is responsible for ensuring that the warranty on the motorcycle is not affected by the fitting of the Products. On return of any defective Products R&G shall at its option either supply a replacement or refund the purchase money but shall not be liable if the Products have been modified or used or maintained otherwise than in accordance with R&G's or manufacturer's instructions and good engineering practice or if the defect arises from accident or neglect. Other than identified above and subject to R&G not limiting its liability for causing death and personal injury, it shall not be liable for indirect or consequential loss and otherwise its liability shall be limited to the amounts paid by the Buyer for the Products or the fitting or service concerned. These terms do not affect the Buyer's statutory rights.

R&G RACING RETURNS POLICY (NON-FAULTY GOODS)

Returns must be pre-authorized (if not pre-authorized the return will be rejected). Goods may only be returned direct to us if they were purchased direct from us (customer must prove if necessary). Otherwise to be returned to original vendor. Goods must be in re-sellable condition, in the opinion of R&G Racing. All returns are subject to a 25% restocking and handling fee (25% of the gross value exc. P&P – at the prevailing price at time of purchase). The customer must pay any and all carriage charges. No returns of discontinued products, unless within 14 days of purchase. This policy does not affect your statutory rights and does not refer to faulty goods.