

Denali Light Mount

BMW R1200GS LC '13-

LAH.07.10400 Instructions Rev:00

PLEASE READ BEFORE INSTALLING

TWISTED THROTTLE products should be installed by a qualified, experienced motorcycle technician. If you are unsure of your ability to properly install a product, please have the product installed by your local motorcycle dealer. TWISTED THROTTLE takes no responsibility for damages caused by improper installation.

All screws, bolts, and nuts, including all replacement hardware provided by TWISTED THROTTLE should be tightened to the torque specified in the OEM maintenance manual for your motorcycle. If no torque specifications are provided in the OEM maintenance manual, the following torques may be used:

M5.....	3.5 ft-lbs (5 Nm)
M6.....	7 ft-lbs (9.6 Nm)
M8.....	13 ft-lbs (18 Nm)

All screws, bolts, and nuts should be checked after driving the first 30 miles (50 km) to ensure that all are tightened to the proper torque.

Medium strength liquid thread-locker (i.e., "Loctite") should be used to secure all screws, bolts, and nuts.

Distributed by:	
Twisted Throttle LLC 570 Moose Neck Rd Exeter, RI 02822	phone: 401.284.4200 fax: 401.223.6955 www.twistedthrottle.com



Kit Contents

1
Rack Bracket (Left)

LAH.07.007
Qty.....1

2
Socket Head Screw

M8x110.....DIN 912
Qty.....2

3
Washer

M8.....DIN 9021
Qty.....4

4
Spacer

OD: 25.4mm, ID: 9mm, L: 80mm
Qty.....2

4
Nylock Nut

M8.....DIN 985
Qty.....2

Step One

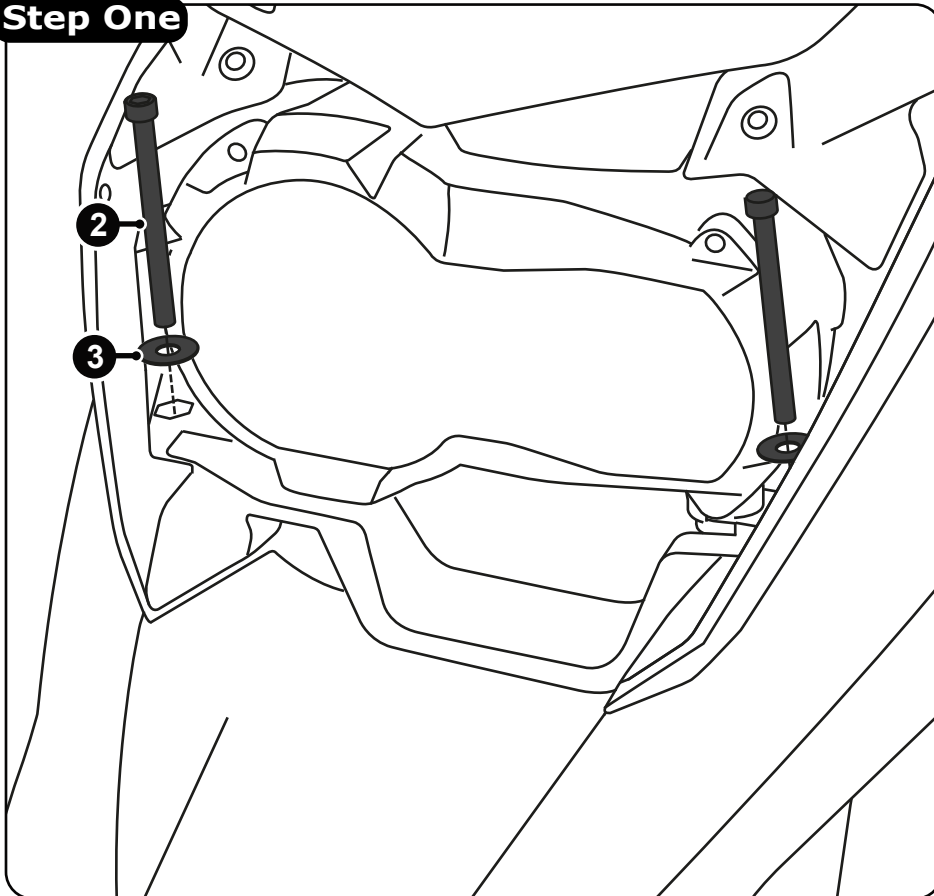

Step Two

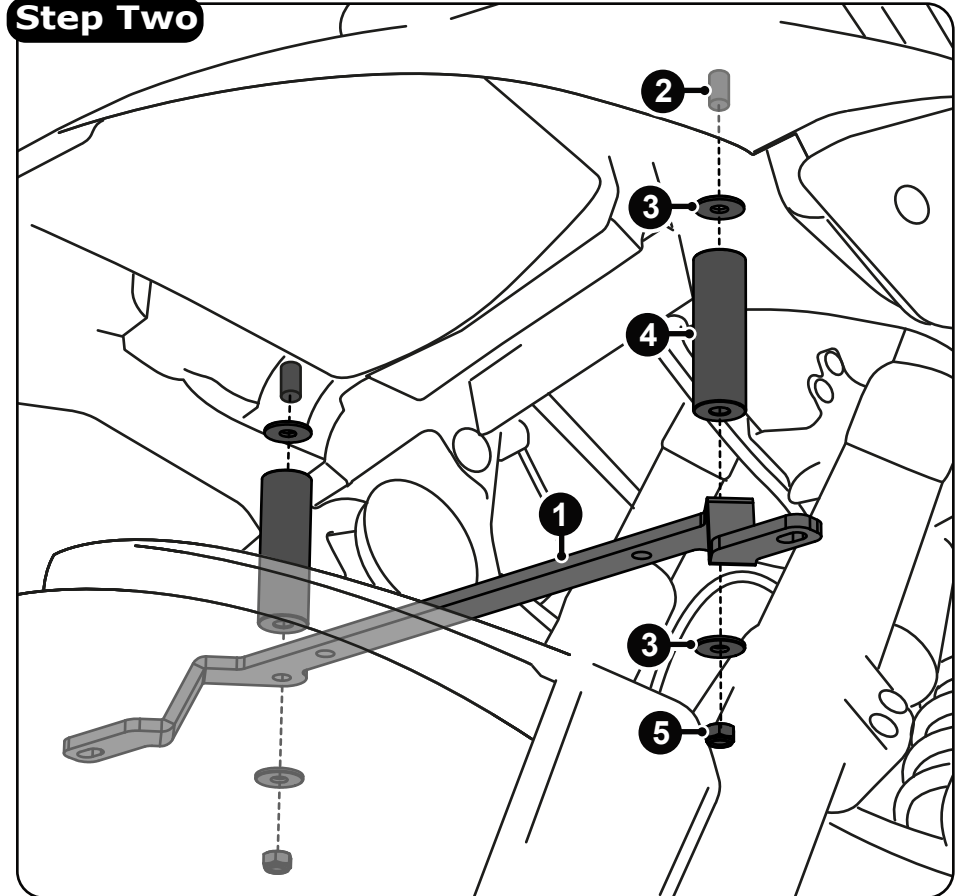

Step One: Place the M8 screws with washers into the openings found on either side of the headlight.

Step Two: Place the spacers over the M8 screws protruding from the underside of the front fender, then mount the bracket in place using the supplied hardware.